

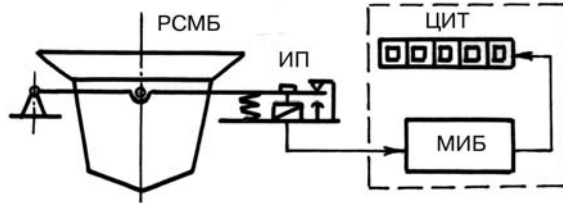

Scales for foundry



Electromechanical single-component
hopper scales for batching of furnace
charge

Stable construction
HM3 – 20...10000 kg
Relative admissible error – 0.2%
Overload ability – 200%

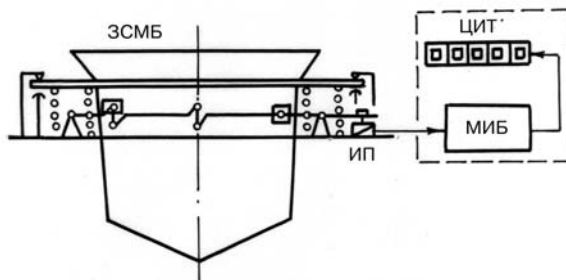

Electromechanical multi-component
hopper scales for batching of furnace
charge

Stable or mobile construction
HM3 – 500; 1000; 2000 kg
Relative admissible error – 0.2%
Overload ability – 200%

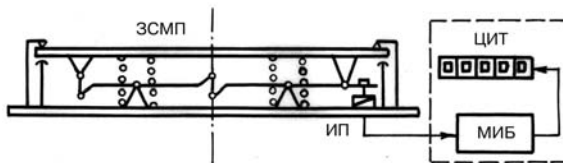

Electromechanical weighbridge for
batching of furnace charge and melts and
for weighing of loads

Stable or mobile construction
HM3 – 100...10000 kg
Relative admissible error – 0.2%
Overload ability – 300%

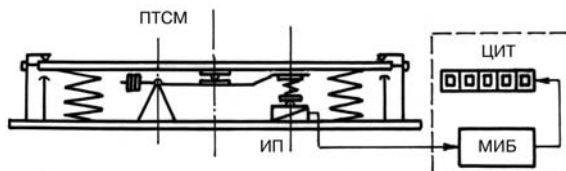

Spring and tensometric weighbridge for
batching of melts and defining of quantity
of cast ingots of the same type in
container by gravimetric method

HM3 – 100; 500; 1000 kg
Stable construction
Relative admissible error – 0.1%

Please forward your proposals and suggestions to:

34/1 Vernadsky Avenue, 03680, Kiev-142, Ukraine, Physico-Technological Institute of Metals and Alloys of the National Academy of Sciences of Ukraine. Tel. (044) 444-35-15, Fax (044) 459-50-29, E-mail: metal@ptima.kiev.ua